

# SW500

## Motorized Pedestrian Gate

The SW500 provides motorized passage control. Front sensors detect approaching patrons, automatically opening the gate to allow passage. Rear presence sensors detect objects in the gate opening swing path and provide an audible warning notification.



### Product Features

- Adjustable opening and closing speeds
- Front and rear IR based motion and presence sensing
- Input for fire systems
- Intelligent motor control technology

### Product Benefits

- Precisely defined motion and presence detection areas
- Directs patron and shopping cart traffic flow
- Touchless operation
- Various user customizable features

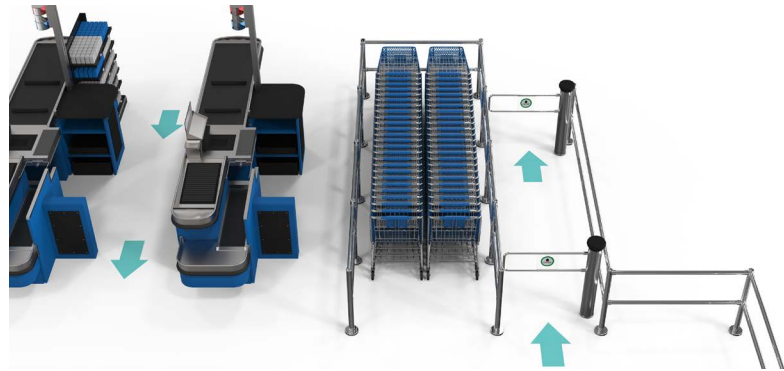
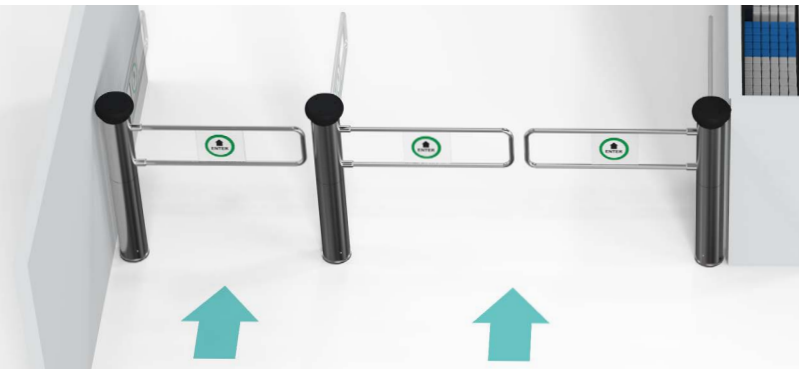

### Available Models

- SW500 Single Gate
- SW500T Tandem Gate with Post and Rail

### Common Applications

- Front of store entry points
- Interior entry points
- Wheelchair / disabled access

### Typical Installation Sites

- Grocery stores
- Retail stores
- Entertainment venues
- Health clubs / Recreation centers

### Options

- Clear acrylic panel replaces metal barrier
- Logo/artwork can be etched on acrylic panel



### Safe and Reliable Operation

- Precise movement and operational control
- Local alarm and available secondary output if manually pushed open in exit direction
- Adjustable opening speed and passage hold-open time
- Can be manually opened if loss of power occurs

### Electrical

- Transformer 110 or 240VAC, 50 - 60Hz
- Operational Voltage VDC, 12/5

### Life Safety and Fire System Integration

The SW500 integrates easily to emergency and fire systems through I/O (dry contact).

### Operating Modes

Single direction entry or exit.

### Available Finishes

- #304 mirror polish stainless steel
- Powder coat

### Dimensions

Dimensions shown in inches (mm).

